

Project: Onderstepoort Solar 2

Portion 4 of Farm Zwaarverdiend No. 234

Remaining Extent of Portion 2 of Farm Onderstepoort No. 98

Remaining Extent of Portion 1 of Farm Elandsfontein No. 102

The Farm Paul Bodenstein Landgoed No. 571

Title: Site Layout Plan

Coordinate System: UTM WGS 84 (Zone 35 S)

Scale: 1: 13 000

Date: March 2025

Drawn by: MCJ

Sheet 1 of 2

- GENERAL NOTES:**
1. Layout is subject to change based on future modelling and considerations.
 2. No on-site accommodation is anticipated for construction purposes. No additional off-site facilities planned at this stage.
 3. Cable trenches will be within or parallel to internal roads and PV Array.
 4. Perimeter fence will surround the facility.
 5. Transformers/Inverters to be placed within the footprint between internal roads and PV module tables.
 6. All areas outside of perimeter fence and access roads are considered no-go areas for construction.
 7. Within the laydown areas, up to 1ha will remain as permanent laydown. The rest of the laydown may be covered by PV arrays.
 8. Guard house to be placed at entry gates. Guard house will be up to 150m2 including parking and ablutions.
 9. Building footprints include parking and ablutions.

| UTM WGS84 (Zone 35 S) | | |
|-----------------------|-----------|------------|
| Point | Easting | Northing |
| A | 500309,78 | 7188049,70 |
| B | 500904,76 | 7188022,29 |
| C | 501109,21 | 7187788,51 |
| D | 501344,13 | 7187754,96 |
| E | 501513,95 | 7187646,05 |
| F | 501536,00 | 7187580,83 |
| G | 501611,37 | 7187139,73 |
| H | 501671,39 | 7186891,80 |
| I | 501556,03 | 7186830,30 |
| J | 501611,04 | 7186717,71 |
| K | 501737,83 | 7186605,42 |
| L | 501771,60 | 7186434,08 |
| M | 501799,51 | 7186292,89 |
| N | 501812,35 | 7186227,99 |
| O | 501690,85 | 7186164,95 |
| P | 501881,83 | 7185778,27 |
| Q | 501901,91 | 7185571,87 |
| R | 501954,40 | 7185445,75 |
| S | 501970,29 | 7185215,04 |
| T | 501946,52 | 7185028,03 |
| U | 502017,42 | 7184789,63 |
| V | 502487,38 | 7186974,68 |
| W | 502035,01 | 7184386,27 |
| X | 501466,06 | 7184032,39 |
| Y | 501202,58 | 7185439,37 |
| Z | 500992,64 | 7186556,28 |
| AA | 499889,39 | 7187275,79 |
| BB | 500401,10 | 7187105,06 |
| CC | 500321,78 | 7187433,89 |
| DD | 499894,42 | 7186620,30 |

Sensitive Areas

- Heritage Buffers
- Aquatic Buffers
- Avifauna High
- Ecology No-Go



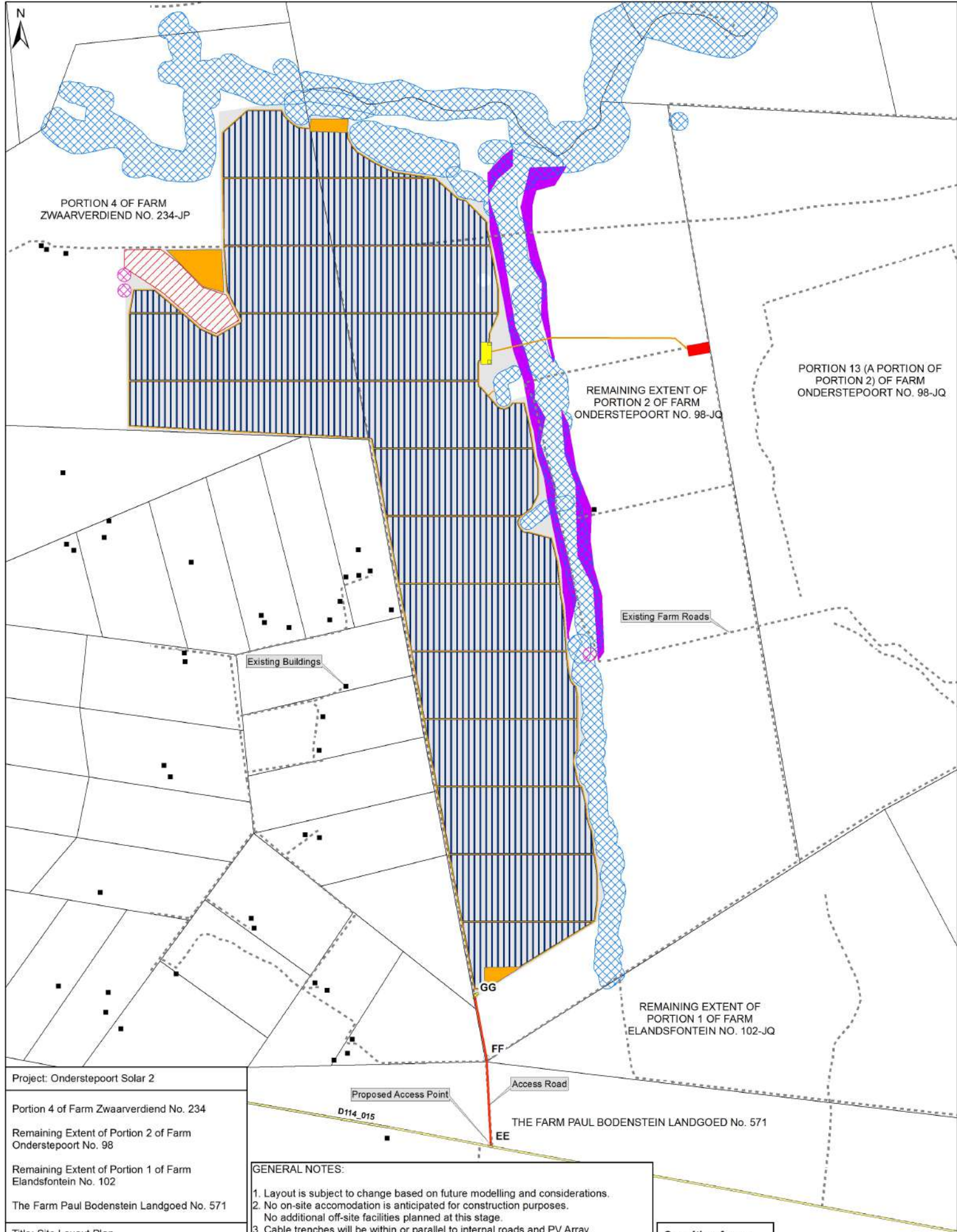

Project: Onderstepoort Solar 2

Portion 4 of Farm Zwaarverdiend No. 234

Remaining Extent of Portion 2 of Farm Onderstepoort No. 98

Remaining Extent of Portion 1 of Farm Elandsfontein No. 102

The Farm Paul Bodenstein Landgoed No. 571

Title: Site Layout Plan

Coordinate System: UTM WGS 84 (Zone 35 S)

Scale: 1: 15 000

Date: March 2025

Drawn by: MCJ

Sheet 2 of 2

- GENERAL NOTES:**
1. Layout is subject to change based on future modelling and considerations.
 2. No on-site accommodation is anticipated for construction purposes. No additional off-site facilities planned at this stage.
 3. Cable trenches will be within or parallel to internal roads and PV Array.
 4. Perimeter fence will surround the facility.
 5. Transformers/Inverters to be placed within the footprint between internal roads and PV module tables.
 6. All areas outside of perimeter fence and access roads are considered no-go areas for construction.
 7. Within the laydown areas, up to 1ha will remain as permanent laydown. The rest of the laydown may be covered by PV arrays.
 8. Guard house to be placed at entry gates. Guard house will be up to 150m2 including parking and ablutions.
 9. Building footprints include parking and ablutions.

Sensitive Areas

- Heritage Buffers
- Aquatic Buffers
- Avifauna High
- Ecology No-Go

| UTM WGS84 (Zone 35 S) | | |
|-----------------------|-----------|------------|
| Point | Easting | Northing |
| EE | 501543,48 | 7183370,26 |
| FF | 501524,00 | 7183765,16 |
| GG | 501471,00 | 7184043,33 |

