

16 November 2020

The Managing Director
ELLENRUST PROPERTIES (PTY) LTD
Bergsig Villas 10
Jan van Riebeeck Street
Oudtshoorn
6625

Dear Sir

COMMENT ON THE DRAFT BAR FOR THE PROPOSED STILBAAI LIFESTYLE VILLAGE ON ERF 4784 (A PORTION OF ERF 657), INCLUDING ERF 4785 (ACCESS ROAD), STILL BAY WEST

Please see our comments on the draft basic assessment report below:

2.2 Alternatives

Original Layout



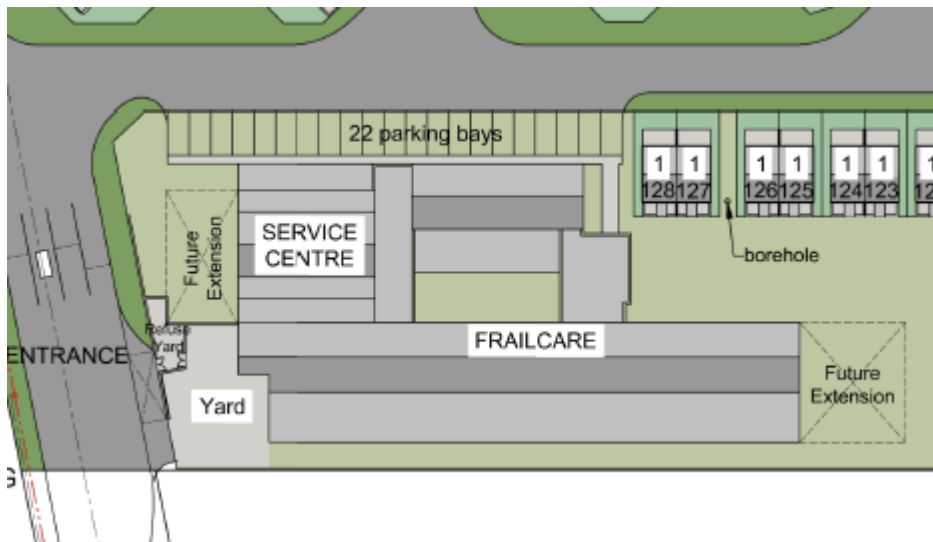

Amended Layout



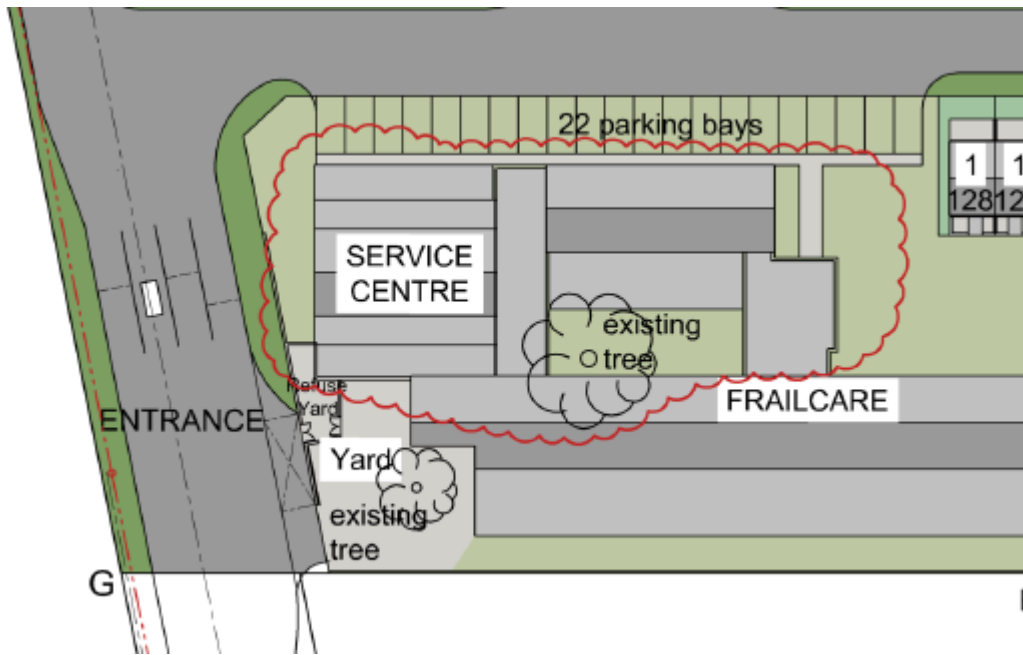

2.2 (d) Alternatives

Green Building criteria have been applied as far as possible. North entry dwellings have exactly the same room orientation layout as South entry dwellings, except for the change in the front door positions as per illustration below.



The shape of the property makes it difficult to have all erven facing true north. The houses along the north-eastern boundary have been designed to allow for maximum sun given the layout parameters as illustrated on the sun study below. This ensures that living areas and bedrooms will benefit from the sun throughout the day

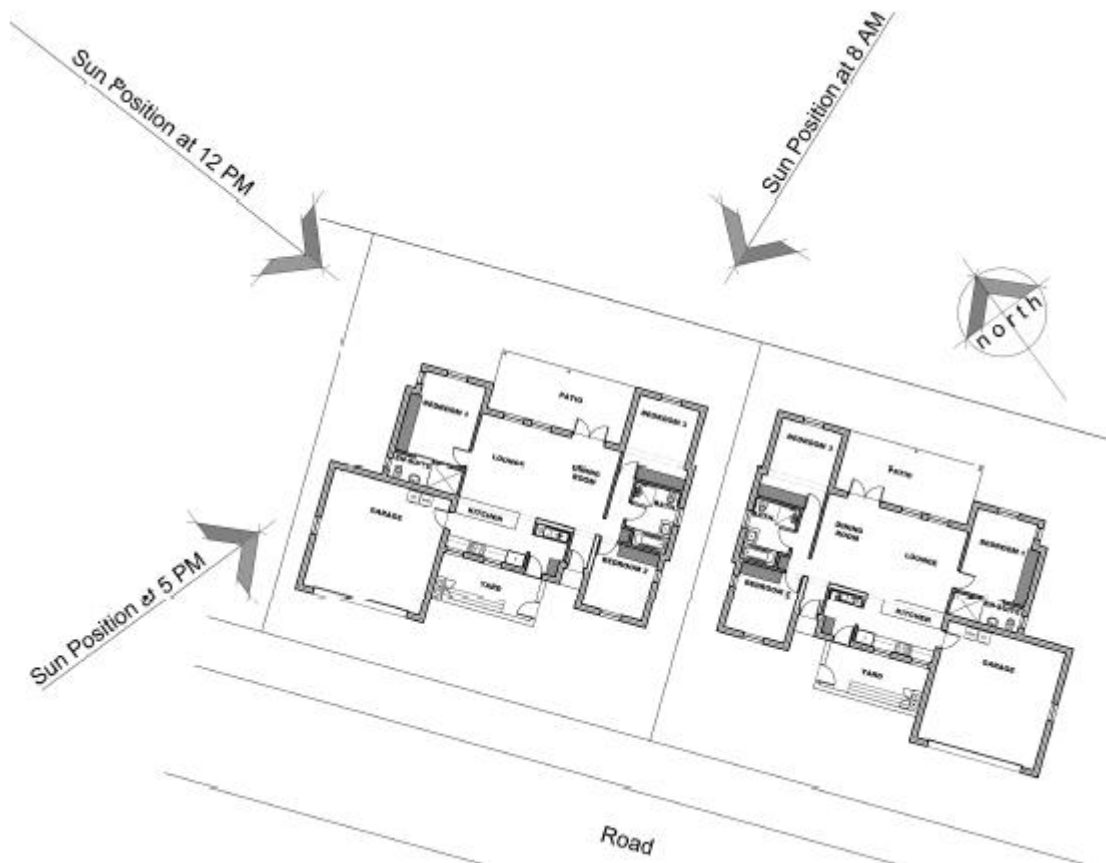

Yours faithfully

A du Toit

SDK ARCHITECTS INC.